

DISNEYLAND® HOTEL — ADVENTURE TOWER

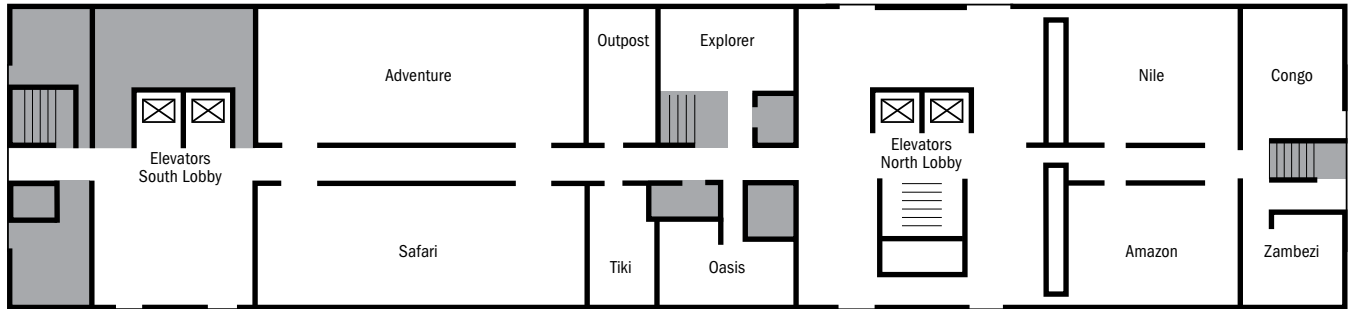

Room Name	Square Feet	Width	Length	Ceiling Height	Theater Style	School Room	U-Shape	Conference	Banquet Rounds	Reception	Exhibit 8'x10'	Exhibit 10'x10'
Adventure	1,403	23	61	10'	130	100	38	50	90	200	7	6
Safari	1,342	22	61	10'	130	100	38	50	90	200	7	6
Outpost	276	12	23	10'	20	15	15	15	20	40	1	1
Tiki	252	12	21	10'	20	15	15	15	20	40	1	1
Explorer	368	16	23	10'	25	18	18	20	20	52	1	1
Oasis	264	12	22	10'	25	15	12	12	20	37	1	1
Nile	840	24	35	10'	70	40	28	30	50	120	4	3
Amazon	805	23	35	10'	70	40	28	30	50	120	4	3
Congo	368	16	23	10'	30	18	18	20	20	50	1	1
Zambezi	240	15	16	10'	18	12	12	12	20	34	1	1

DISNEYLAND® HOTEL — MONORAIL & CASTLE

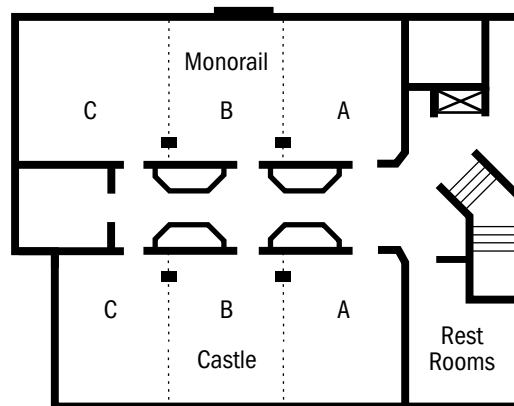

Room Name	Square Feet	Width	Length	Ceiling Height	Theater Style	School Room	U-Shape	Conference	Banquet Rounds	Reception	Exhibit 8'x10'	Exhibit 10'x10'
Monorail Room	2,516	34	74	9'	250	150	45	60	160	364	12	10
Monorail C	748	34	22	9'	49	40	27	30	49	49	5	4
Monorail B	714	34	21	9'	49	40	27	30	49	49	5	4
Monorail A	782	34	23	9'	49	40	27	30	49	49	5	4
Monorail C & B	1,598	34	47	9'	150	90	38	45	100	233	7	6
Monorail B & A	1,632	34	48	9'	150	90	38	45	100	233	7	6
Castle Room	2,550	34	75	9'	250	150	45	60	160	364	12	10
Castle C	748	34	22	9'	49	40	27	30	49	49	5	4
Castle B	714	34	21	9'	49	40	27	30	49	49	5	4
Castle A	782	34	23	8'6"	49	40	27	30	49	49	5	4
Castle B & C	1,598	34	47	9'	150	90	38	45	100	233	7	6
Castle B & A	1,632	34	48	9'	150	90	38	45	100	233	7	6
Lower Exhibit Hall*	50,000	193	309	8'6"	•	•	•	•	1,000	2,500	245	224

* Interior parking facility

DISNEYLAND® HOTEL — FRONTIER TOWER

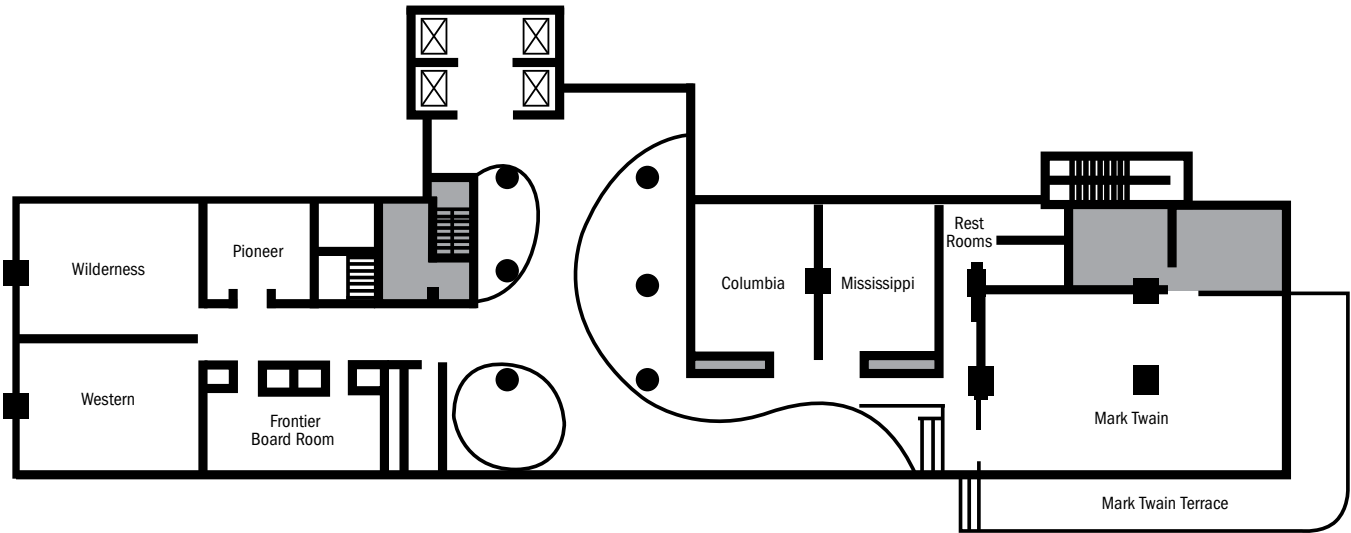

Room Name	Square Feet	Width	Length	Ceiling Height	Theater Style	School Room	U-Shape	Conference	Banquet Rounds	Reception	Exhibit 8'x10'	Exhibit 10'x10'
Wilderness	754	26	29	11'	60	40	24	26	50	107	5	4
Western	754	26	29	11'	60	40	24	26	50	107	5	4
Pioneer	320	16	20	11'	25	12	12	12	20	45	2	1
Frontier Board Room	576	16	36	11'	•	•	•	20	•	•	•	•
Columbia	660	28	23	11'	44	40	22	24	44	44	5	4
Mississippi	630	28	22	11'	42	40	22	24	42	42	5	4
Mark Twain	2,016	36	56	11'	100	70	34	36	160	288	8	7

NOTE: Capacity figures subject to change depending on space allocations for head table, dance floor, staging and hors d'oeuvres layout.

DISNEYLAND® HOTEL — LOWER LEVEL

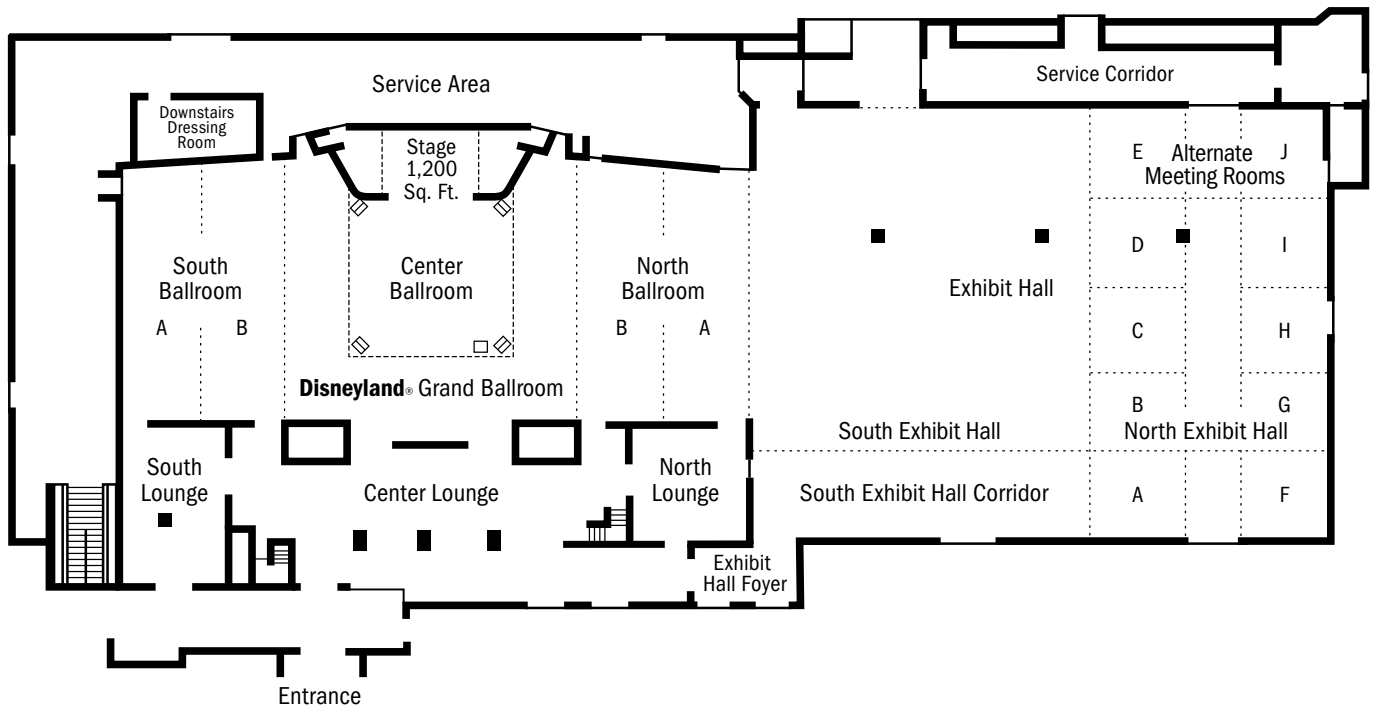

Room Name	Square Feet	Width	Length	Ceiling Height	Theater Style	School Room	U-Shape	Conference	Banquet Rounds	Reception	Exhibit 8'x10'	Exhibit 10'x10'
Grand Ballroom	18,000	90	200	18'	1,620	870	•	•	1,000	1,900	94	89
South Ballroom*	4,620	55	84	18'	400	250	60	50	350	660	26	19
Center Ballroom	8,835	95	93	18'	720	410	60	45	500	1,232	40	39
Center Ballroom Expanded	14,006	151	100	18'	1,070	540	60	45	740	1,832	66	55
North Ballroom*	4,620	55	84	18'	400	250	30	50	350	660	26	19
South Lounge	1,908	53	36	9'8"	120	80	•	30	80	270	6	5
Center Lounge	3,120	45	76	10'1"	•	•	•	•	•	445	6	4
North Lounge	1,404	36	39	9'4"	•	•	•	•	•	200	6	5
Grand Ballroom Registration Area	1,375	25	55	9'8"	•	•	•	•	•	•	•	•
Exhibit Hall	28,968	142	204	18'	2,800	1,500	•	•	1,860	3,000	193	170
South Exhibit Hall	15,904	142	112	18'	1,500	650	•	•	900	2,292	108	89
North Exhibit Hall	12,070	142	85	18'	900	550	•	•	900	1,794	72	71
Meeting Rooms (each)	•	A-E: 33'6" F-J: 37'6"		18'	60	50	25	25	50	100	6	5

* North and South Ballrooms may be divided as shown by thin dotted lines.

(WIDTH VARIES MEETING ROOMS A - J: 26'6" - 32'6")

Exhibit Hall power available. 3 phase per outlet.

Load limits: 125 lbs. per sq. ft.

Hall lighting: 80+ candlepower floor level.

Compressed air available.

DISNEYLAND® HOTEL — UPPER LEVEL

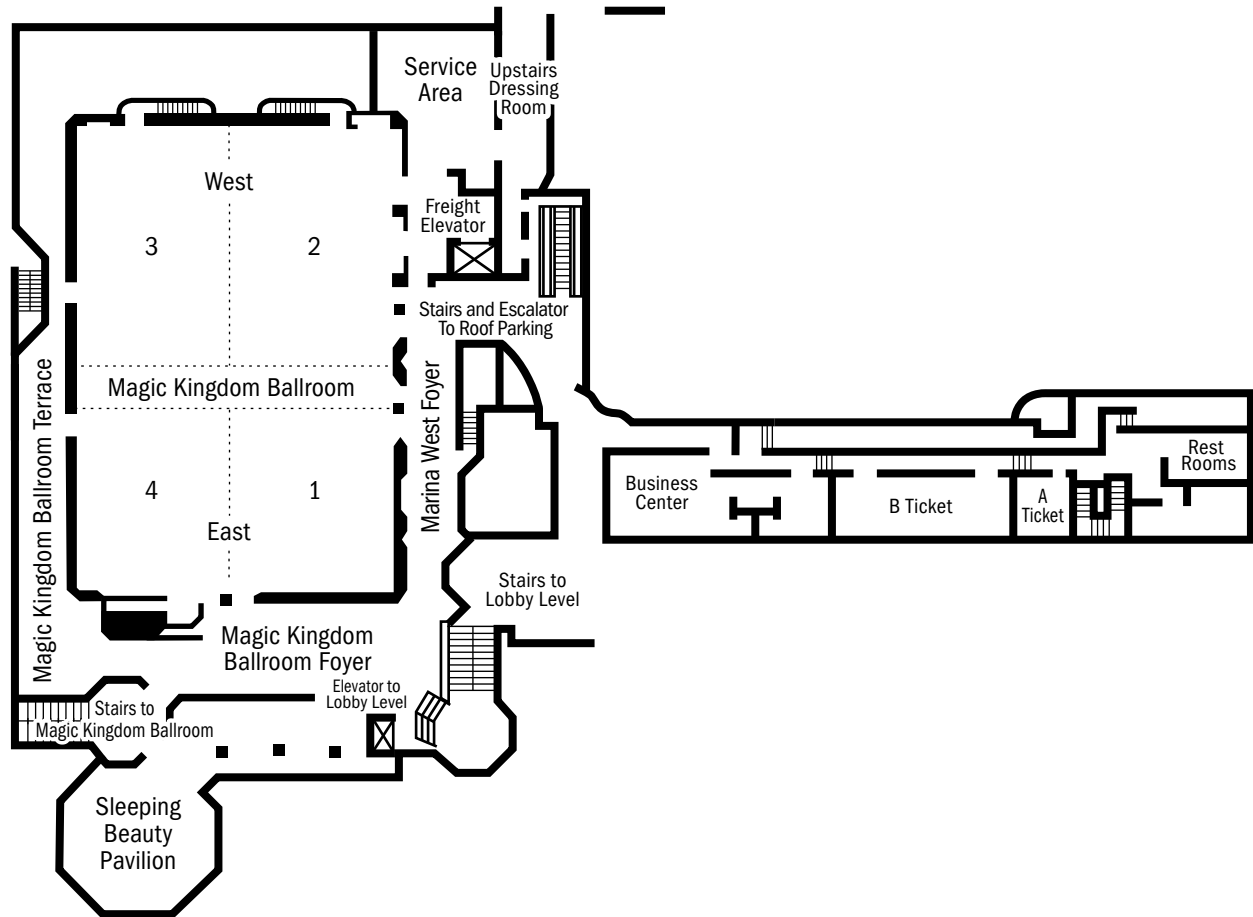

Room Name	Square Feet	Width	Length	Ceiling Height	Theater Style	School Room	U-Shape	Conference	Banquet Rounds	Reception	Exhibit 8'x10'	Exhibit 10'x10'
Magic Kingdom Ballroom* (full)	14,400	100	144	17'	1,500	800	•	•	960	1,600	85	72
Magic Kingdom West Expanded (2/3)	8,600	100	86	17'	800	470	•	•	560	1,218	44	34
Ballrooms 2 & 3 (half)	7,100	100	71	17'	600	396	•	•	480	1,014	41	31
Ballrooms 1 & 4 (1/3)	5,390	98	55	17'	500	240	•	•	320	770	32	26
Ballroom 1	2,695	49	55	17'	250	120	45	60	160	385	16	10
Ballroom 2	3,479	49	71	17'	300	198	55	70	240	479	22	17
Ballroom 3	3,479	49	71	17'	300	198	55	70	240	479	22	17
Ballroom 4	2,695	49	55	17'	250	120	45	60	160	385	16	10
Sleeping Beauty Pavilion	3,645	•	•	14'	200	120	46	40	200	300	•	•
B Ticket**	1,044	58	18	10'	100	52	26	35	60	149	•	•
A Ticket**	324	18	18	10'	25	12	10	16	12	30	•	•

Listed capacities do not include audio visual or other additional equipment

* Free span construction (no pillars). Movable soundproof walls. Roll-up door: 9' x 10'. Freight elevator: 8'8" (h) x 8' (d). Capacity: 5,500 lbs.

** Suitable for meetings, offices or press rooms.

Load Limits: 55lbs. per sq. ft.